

PARK MANSIONS, KNIGHTSBRIDGE, LONDON

£1,895 PW



MAYFAIR SQUARE

1 Mayfair Place, London W1J 8AJ, United Kingdom

+44 (0)207 184 9888 | info@mayfairsquare.co.uk | www.mayfairsquare.co.uk

PARK MANSIONS, KNIGHTSBRIDGE, LONDON

£1,895 PW

PROPERTY DESCRIPTION

Luxury Two-Bedroom Apartment Moments from Harrods.

A beautifully presented and spacious two-bedroom, two-bathroom apartment ideally located just moments from Harrods and Hyde Park, in the heart of Knightsbridge. This stylish property spans over 1,000 sq ft and offers a thoughtfully designed open-plan living area, complete with a dedicated dining space and a luxury kitchen featuring a breakfast bar and high-end finishes.

Both bedrooms are well-proportioned, and the apartment boasts beautiful wood flooring, high ceilings, and an abundance of natural light throughout. The property also benefits from 24-hour portage, providing security and convenience, with hot water included in the rent.

Situated in an exceptional location, with world-class shopping, dining, and green space on your doorstep, this apartment offers a truly premium lifestyle in one of London's most prestigious neighbourhoods.

Arrange a private viewing today with our team at Mayfair Square to see this exceptional property.

Lifestyle & Location

Located in the heart of Knightsbridge, the apartment offers immediate access to world-class shopping and dining. Just moments from Harrods, Harvey Nichols, and the designer boutiques of Sloane Street, the area is home to global luxury brands such as Tom Ford, Louis Vuitton, Chanel, and Cartier. Residents can also enjoy an array of Michelin-starred restaurants and fine dining experiences.

For leisure and relaxation, the expansive Hyde Park is just a short stroll away, offering 350 acres of open green space, lakes, walking trails, and recreational activities.

The property also benefits from excellent transport links, with Knightsbridge, Sloane Square, and South Kensington Underground stations all within easy reach, providing fast access across Central London and beyond.



MAYFAIR SQUARE

1 Mayfair Place, London W1J 8AJ, United Kingdom

+44 (0)207 184 9888 | info@mayfairsquare.co.uk | www.mayfairsquare.co.uk

PARK MANSIONS, KNIGHTSBRIDGE, LONDON

£1,895 PW



MAYFAIR SQUARE

1 Mayfair Place, London W1J 8AJ, United Kingdom

+44 (0)207 184 9888 | info@mayfairsquare.co.uk | www.mayfairsquare.co.uk



MAYFAIR SQUARE

1 Mayfair Place, London W1J 8AJ, United Kingdom

+44 (0)207 184 9888 | info@mayfairsquare.co.uk | www.mayfairsquare.co.uk

Park Mansions, SW1X

Approximate Gross Internal Area = 102 sq m / 1098 sq ft

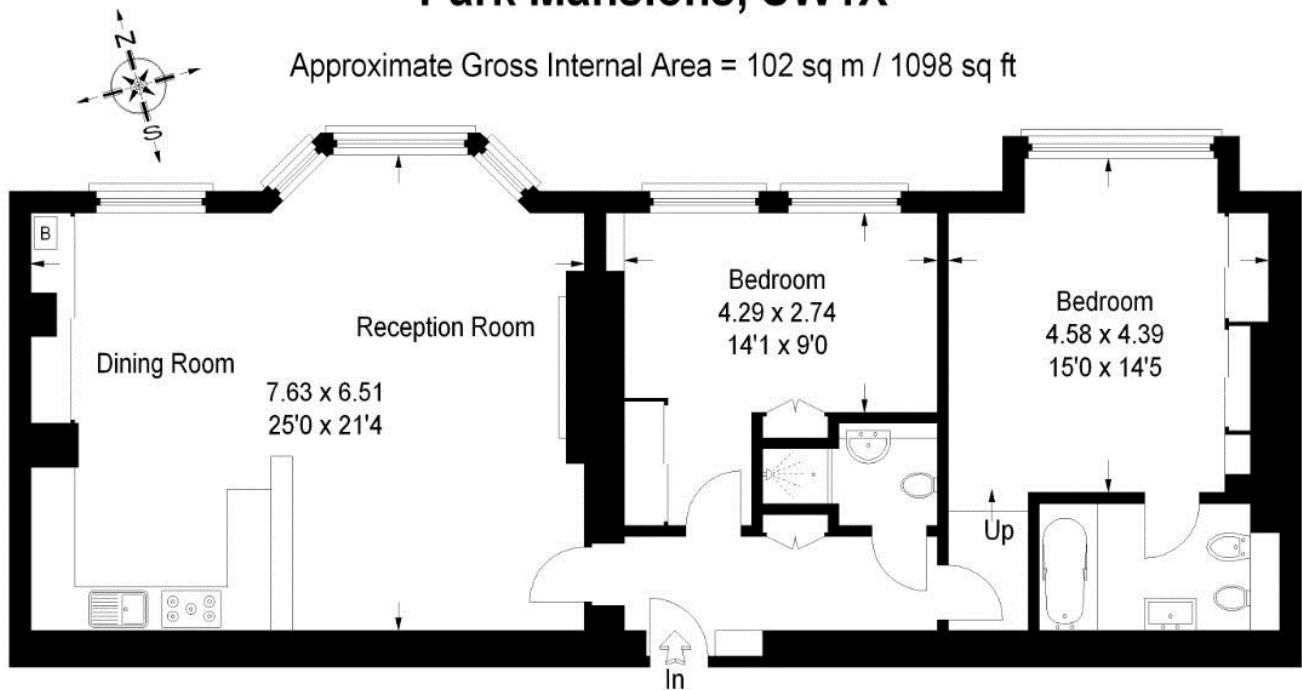

FLOORPLANZ © 2013 0845 6344080 Ref 117588

This plan is for layout guidance only. Not drawn to scale unless stated. Windows & door openings are approximate. Whilst every care is taken in the preparation of this plan, please check all dimensions, shapes & compass bearings before making any decisions reliant upon them.



MAYFAIR SQUARE

1 Mayfair Place, London W1J 8AJ, United Kingdom

+44 (0)207 184 9888 | info@mayfairsquare.co.uk | www.mayfairsquare.co.uk

PARK MANSIONS, KNIGHTSBRIDGE, LONDON

£1,895 PW

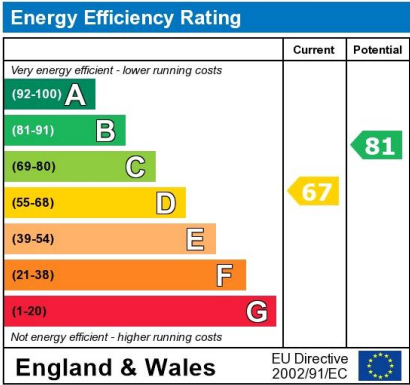
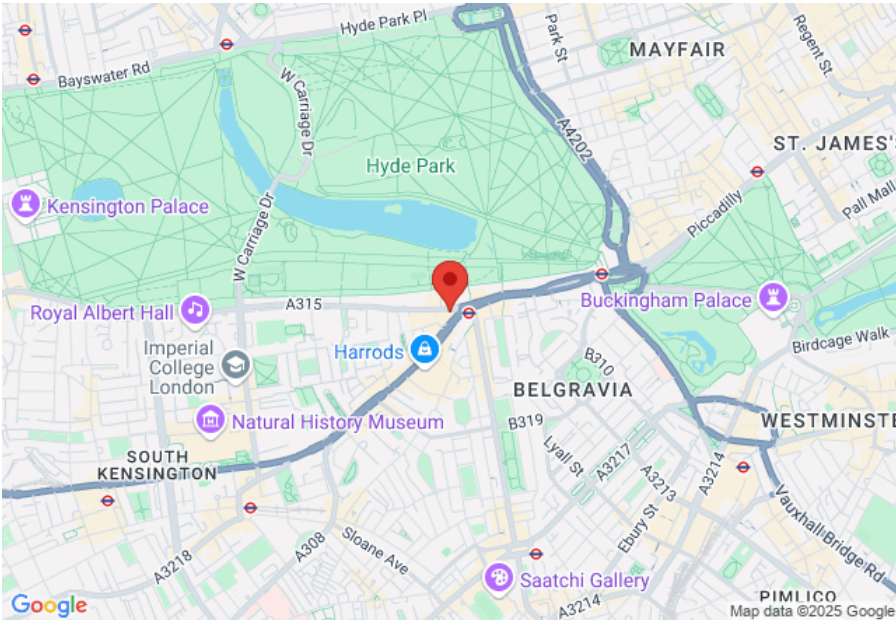

The energy efficiency rating is a measure of the overall efficiency of a home. The higher the rating the more energy efficient the home is and the lower the fuel bills will be.



MAYFAIR SQUARE

1 Mayfair Place, London W1J 8AJ, United Kingdom

+44 (0)207 184 9888 | info@mayfairsquare.co.uk | www.mayfairsquare.co.uk

PARK MANSIONS, KNIGHTSBRIDGE, LONDON

£1,895 PW

FOR MORE INFORMATION PLEASE CONTACT US

Important Notice:

Particulars: These particulars are not an offer or contract, nor part of one. You should not rely on statements by Mayfair Square in the particulars or by word of mouth or in writing ("information") as being factually accurate about the property, its condition or its value. Neither Mayfair Square nor any joint agent has any authority to make any representations about the property, and accordingly any information given is entirely without responsibility on the part of the agents, seller(s), lessor(s) or landlord(s).

Any areas, measurements or distances are approximate. The text, photographs and plans are for guidance only and are not necessarily comprehensive. Regulations etc: Any reference to alterations to, or use of, any part of the property does not mean that any necessary planning, building regulations or other consent has been obtained. A buyer or lessee must find out by inspection or in other ways that these matters have been properly dealt with and that all information is correct.



MAYFAIR SQUARE

1 Mayfair Place, London W1J 8AJ, United Kingdom

+44 (0)207 184 9888 | info@mayfairsquare.co.uk | www.mayfairsquare.co.uk
