

SOMERSET ROAD, LONDON

£950,000



MAYFAIR SQUARE

1 Mayfair Place, London W1J 8AJ, United Kingdom

+44 (0)207 184 9888 | info@mayfairsquare.co.uk | www.mayfairsquare.co.uk

SOMERSET ROAD, LONDON

£950,000

PROPERTY DESCRIPTION

An exquisite luxury three-bedroom apartment in a distinguished new development, perfectly positioned in the heart of Ealing. This prime location combines the tranquillity of a peaceful residential neighbourhood with the convenience of being close to all the vibrant offerings of the area.

This apartment is thoughtfully designed to enhance space and light, offering a modern and welcoming atmosphere. Its open-plan reception area flows seamlessly into a high-end kitchen, complete with marble worktops from Verona, Italy, perfect for both everyday living and entertaining. The apartment includes three spacious double bedrooms, with the master featuring a stylish en-suite bathroom. The second modern bathroom serves the other two bedrooms, both bathrooms boasting sleek and contemporary finishes.

A key highlight of the apartment is its private terrace, providing a peaceful outdoor space for relaxation or entertainment. The interior is further elevated by elegant Herringbone flooring and underfloor heating throughout, offering both luxury and warmth during colder months.

Located in a highly sought-after and quiet residential pocket of Ealing, the property offers the perfect balance of city living with green spaces nearby. Walpole Park, with its beautiful gardens and scenic views, is just a short walk away, providing a peaceful retreat for leisurely walks, picnics, or outdoor activities.

The property is conveniently located near West Ealing and North Ealing stations, offering quick access to the Elizabeth Line for an 8-minute journey into central London, ideal for commuters and city-goers. Additionally, it's close to the high street, with a variety of shops, cafes, restaurants.

This development offers an exceptional lifestyle in a highly desirable area, combining luxury living, modern convenience, and an unbeatable location. Ideal for families, professionals, or investors, the apartments represent a rare opportunity to own a home in one of Ealing's finest new developments.

Please note photographs are CGI's (Computer-generated imagery) and are only for guidance.



MAYFAIR SQUARE

1 Mayfair Place, London W1J 8AJ, United Kingdom

+44 (0)207 184 9888 | info@mayfairsquare.co.uk | www.mayfairsquare.co.uk

SOMERSET ROAD, LONDON
£950,000



MAYFAIR SQUARE

1 Mayfair Place, London W1J 8AJ, United Kingdom

+44 (0)207 184 9888 | info@mayfairsquare.co.uk | www.mayfairsquare.co.uk



MAYFAIR SQUARE

1 Mayfair Place, London W1J 8AJ, United Kingdom

+44 (0)207 184 9888 | info@mayfairsquare.co.uk | www.mayfairsquare.co.uk

BUILDING A
LOWER GROUND
GROUND FLOOR

APT No. A.1
3-BEDROOMS DUPLEX

1,258 SQ FT / 116.9 SQ M
EXCLUDING TERRACE

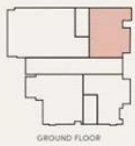

LOWER GROUND

GROUND FLOOR



MAYFAIR SQUARE

1 Mayfair Place, London W1J 8AJ, United Kingdom

+44 (0)207 184 9888 | info@mayfairsquare.co.uk | www.mayfairsquare.co.uk

SOMERSET ROAD, LONDON

£950,000



MAYFAIR SQUARE

1 Mayfair Place, London W1J 8AJ, United Kingdom

+44 (0)207 184 9888 | info@mayfairsquare.co.uk | www.mayfairsquare.co.uk

SOMERSET ROAD, LONDON
£950,000

FOR MORE INFORMATION PLEASE CONTACT US

Important Notice:

Particulars: These particulars are not an offer or contract, nor part of one. You should not rely on statements by Mayfair Square in the particulars or by word of mouth or in writing ("information") as being factually accurate about the property, its condition or its value. Neither Mayfair Square nor any joint agent has any authority to make any representations about the property, and accordingly any information given is entirely without responsibility on the part of the agents, seller(s), lessor(s) or landlord(s).

Any areas, measurements or distances are approximate. The text, photographs and plans are for guidance only and are not necessarily comprehensive. Regulations etc: Any reference to alterations to, or use of, any part of the property does not mean that any necessary planning, building regulations or other consent has been obtained. A buyer or lessee must find out by inspection or in other ways that these matters have been properly dealt with and that all information is correct.



MAYFAIR SQUARE

1 Mayfair Place, London W1J 8AJ, United Kingdom

+44 (0)207 184 9888 | info@mayfairsquare.co.uk | www.mayfairsquare.co.uk
